

※別売りの「NB-019 ナノブロック専用ピンセット」や「NB-020 ナノブロックパッド」を使うと組み立て、取りはずしに便利です。 Use "NB-019 nanoblock Tweezers" and "NB-020 nanoblock Pad" (each sold separately) for an easy way to assemble and disassemble blocks.

Parts list for step 1-6. Includes quantities for White, Gray, Clear Blue, Clear, and Light Gray blocks.

Assembly steps 1-6. Step 1: Attach 1x15 and 1x2 white blocks. Step 2: Attach 1x4 and 1x10 gray blocks. Step 3: Attach 1x4 and 1x10 gray blocks. Step 4: Attach 1x4 and 1x10 gray blocks. Step 5: Attach 1x4 and 1x10 gray blocks. Step 6: Attach 1x4 and 1x10 gray blocks.

Assembly steps 7-14. Step 7: Attach 1x4 and 1x10 gray blocks. Step 8: Attach 1x4 and 1x10 gray blocks. Step 9: Attach 1x4 and 1x10 gray blocks. Step 10: Attach 1x4 and 1x10 gray blocks. Step 11: Attach 1x4 and 1x10 gray blocks. Step 12: Attach 1x4 and 1x10 gray blocks. Step 13: Attach 1x4 and 1x10 gray blocks. Step 14: Turn the body over.

Assembly steps 15-25. Step 15: Attach 1x4 and 1x10 gray blocks. Step 16: Attach 1x4 and 1x10 gray blocks. Step 17: Attach 1x4 and 1x10 gray blocks. Step 18: Attach 1x4 and 1x10 gray blocks. Step 19: Attach 1x4 and 1x10 gray blocks. Step 20: Attach 1x4 and 1x10 gray blocks. Step 21: Rear side view. Step 22: Attach 1x4 and 1x10 gray blocks. Step 23: Attach 1x4 and 1x10 gray blocks. Step 24: Attach 1x4 and 1x10 gray blocks. Step 25: Attach 1x4 and 1x10 gray blocks.

Assembly steps 26-35. Step 26: Attach 1x4 and 1x10 gray blocks. Step 27: Attach 1x4 and 1x10 gray blocks. Step 28: Attach 1x4 and 1x10 gray blocks. Step 29: Attach 1x4 and 1x10 gray blocks. Step 30: Attach 1x4 and 1x10 gray blocks. Step 31: Attach 1x4 and 1x10 gray blocks. Step 32: Attach 1x4 and 1x10 gray blocks. Step 33: Attach 1x4 and 1x10 gray blocks. Step 34: Attach 1x4 and 1x10 gray blocks. Step 35: Attach 1x4 and 1x10 gray blocks.

Assembly steps 36-43. Step 36: Attach 1x4 and 1x10 gray blocks. Step 37: Attach 1x4 and 1x10 gray blocks. Step 38: Turn the body over. Step 39: Attach 1x4 and 1x10 gray blocks. Step 40: Attach 1x4 and 1x10 gray blocks. Step 41: Turn the body over. Step 42: Attach 1x4 and 1x10 gray blocks. Step 43: Attach 1x4 and 1x10 gray blocks.

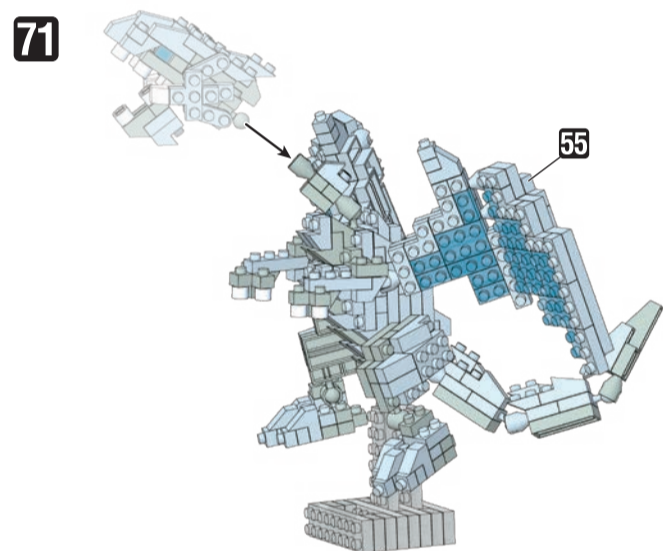
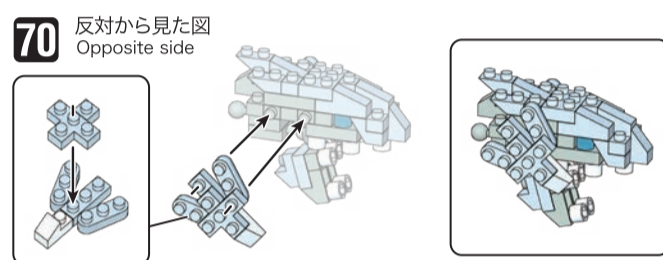
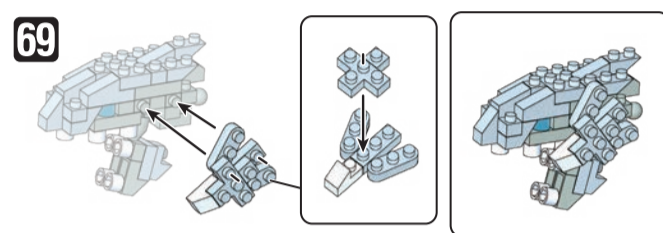
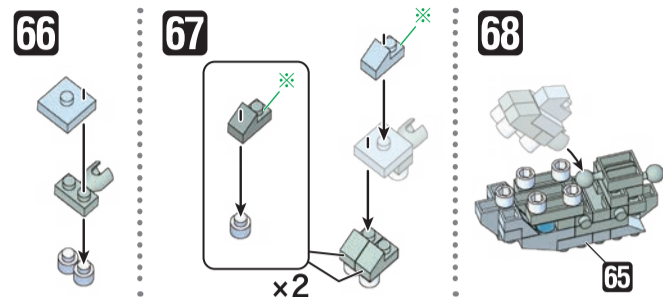
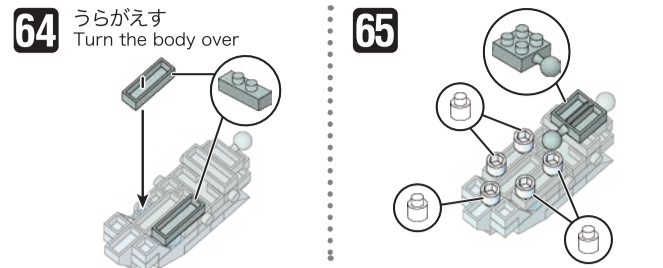
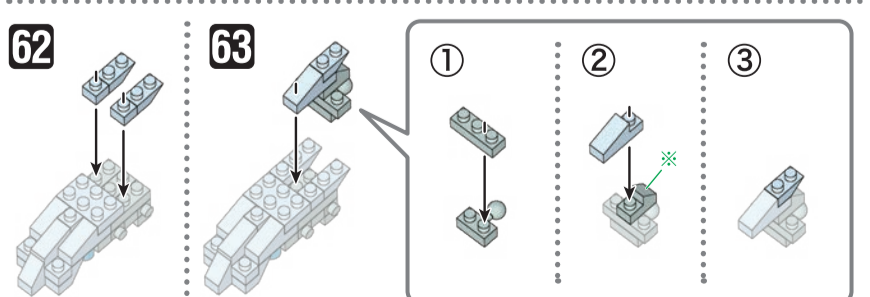
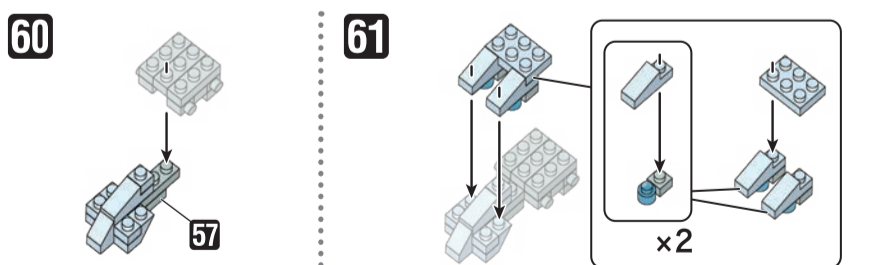
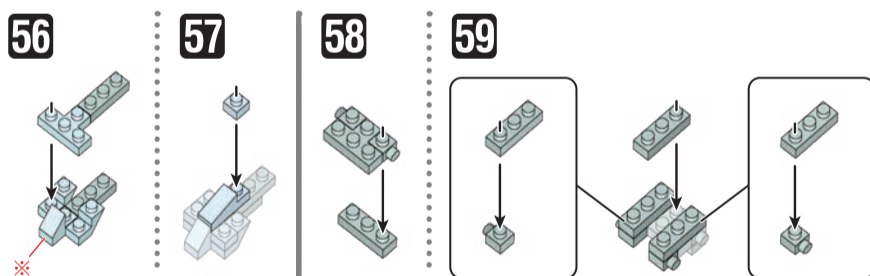
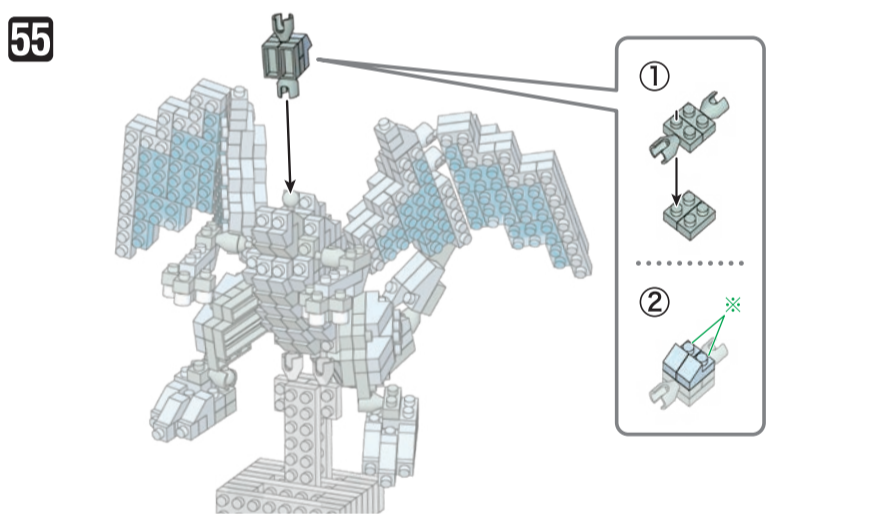
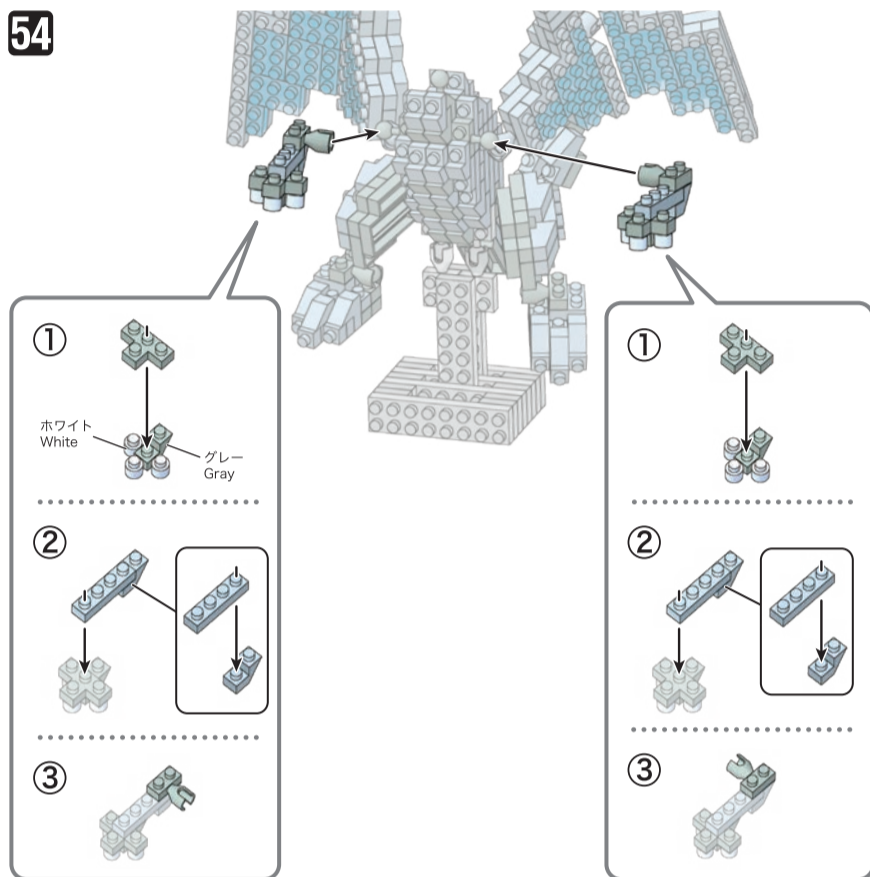
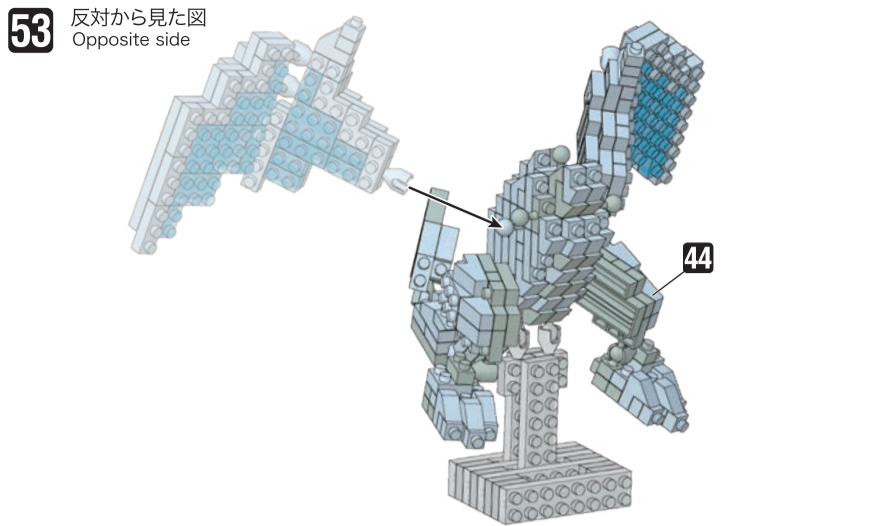
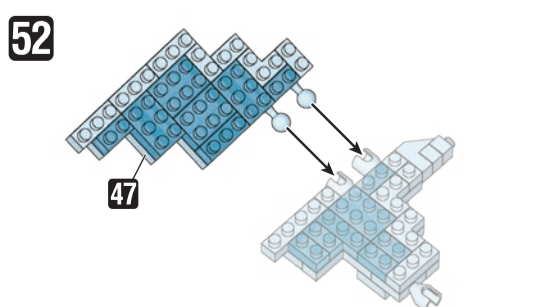
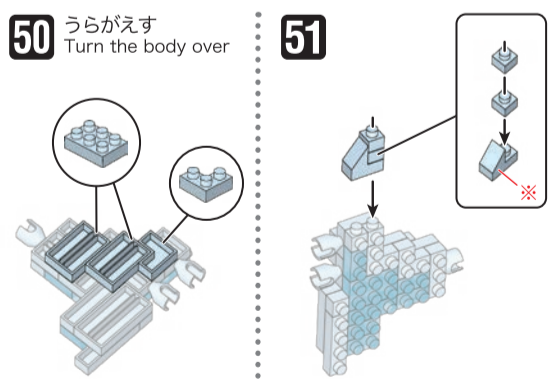
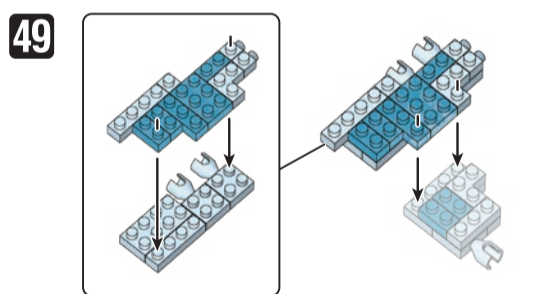
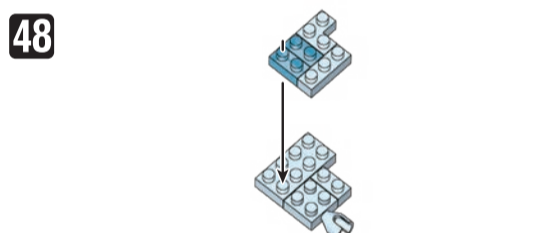
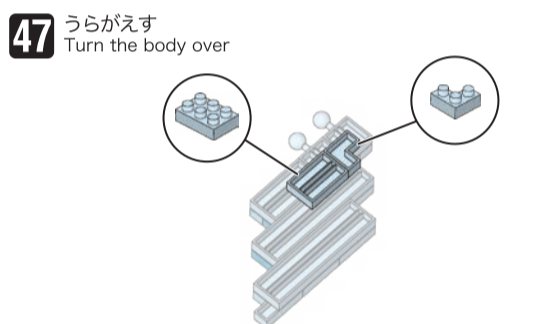
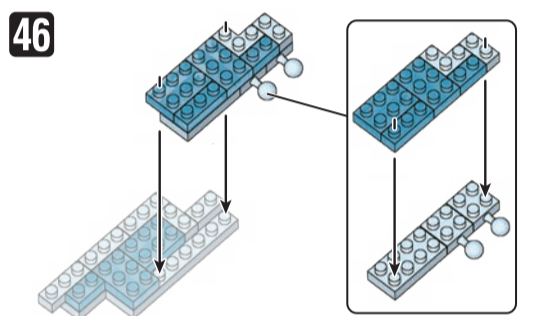
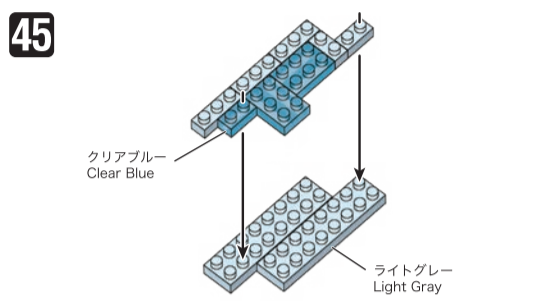
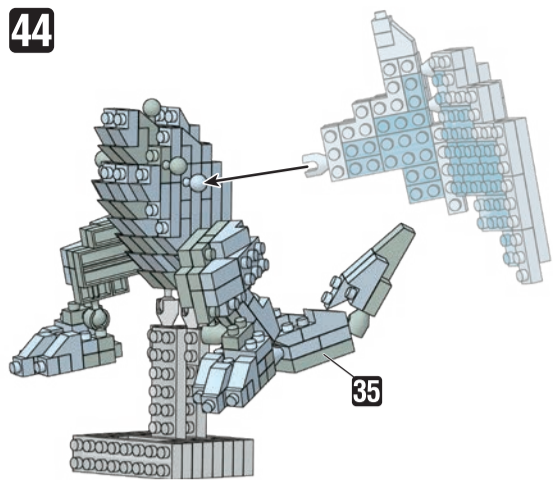

下記のパーツを使用することで翼を固定できます。
The wings can be fixed by using the parts below.

クリア Clear x6

クリア Clear x1

よこから見た図
Side view

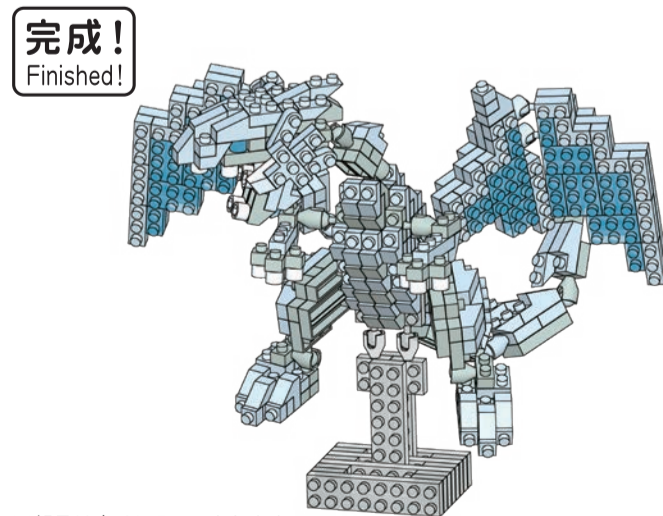

※部品は多めに入っております
Extra blocks included